

Model A Ford TRANSMISSION 1928-1931

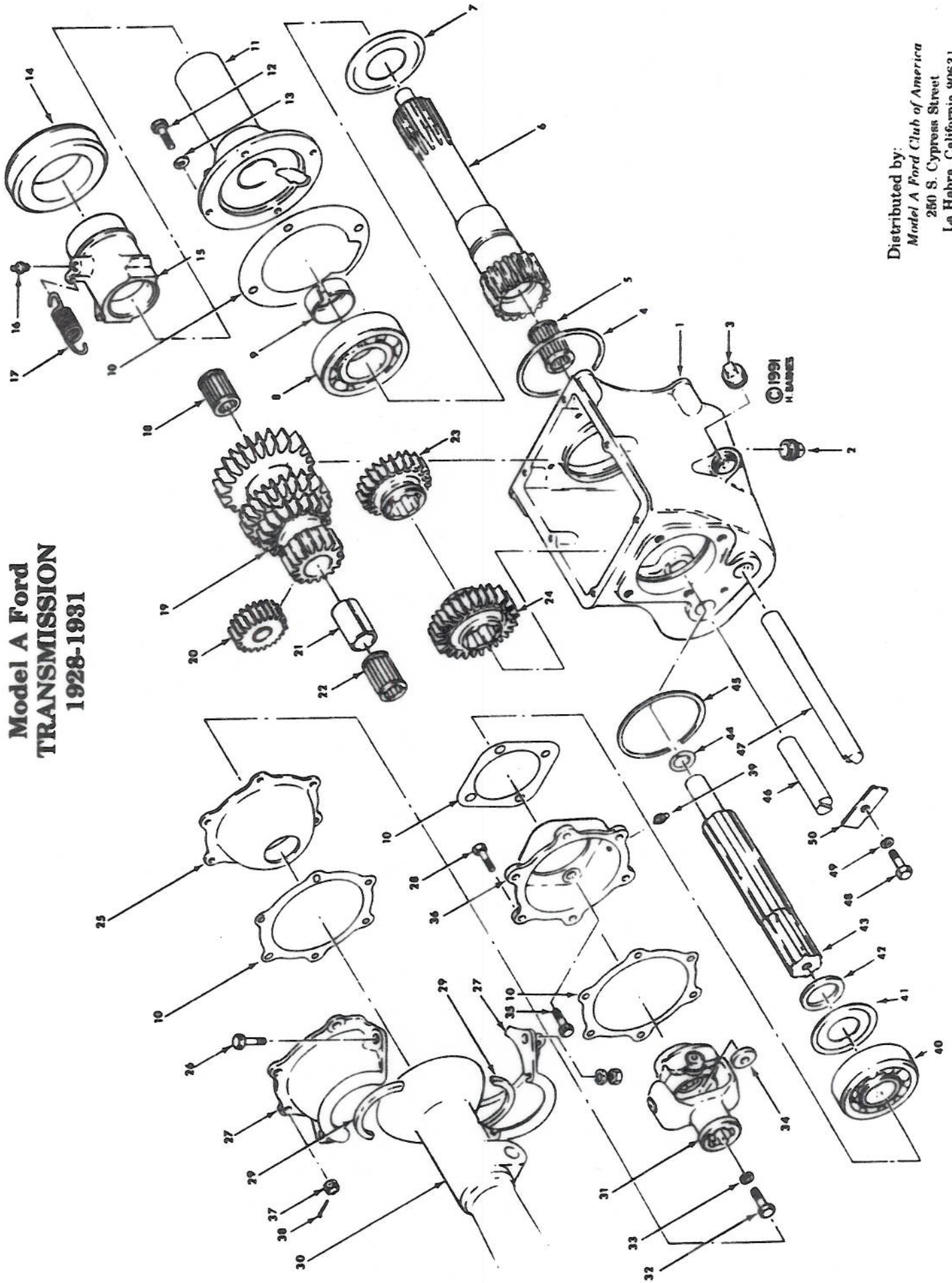

Distributed by:
Model A Ford Club of America
 250 S. Cypress Street
 La Habra, California 90631

©1991
 H. BARNES

Model A Ford
TRANSMISSION
1928-1931

Index Number	Part Number	Nomenclature	Number Required
1	A-7006-B	Transmission Case	1
2	A-24452	Oil Drain Plug 3/4" (x 15/16 sq) (Pipe Plug)	1
3	A-24452	Oil Filler Plug 3/4" (x 15/16 sq) (Pipe Plug)	1
4	A-7045-B	Main Driver Gear Snap Ring	1
5	A-7118	Main Drive Shaft Bearing	1
6	A-7017-B	Main Drive Gear	1
7	A-7040-B	Main Drive Gear Bearing Baffle	1
8	A-7025-B	Main Drive Gear Bearing	1
9	A-1180-B	Retainer Snag Ring	1
10	A-7051	Bearing Retainer Gasket	1
11	A-7050	Bearing Retainer	1
12	A-20718	Hex Head Bolt 5/16"-18 (x 7/8)	4
13	A-22217	Lockwasher 5/16" (3/32 x 37/64)	4
14	A-7580-B	Throw-out Bearing	1
15	A-7561-B	Clutch Release Bearing Hub	1
16	A-24405	Grease Fitting	1
17	A-7562	Throw-out Bearing Spring	1
18	A-7118	Cluster Gear Bearing (Short)	1
19	A-7113	Cluster Gear	1
-	* A-7120	Brass Thrust Washer	2
20	A-7141	Reverse Idler Gear & Bushing Assembly	1
21	A-7115	Cluster Gear Spacer	1
22	A-7121	Cluster Gear Bearing (Long)	1
23	A-7101	Second & High Sliding Gear (Small)	1
24	A-7100	Low & Reverse Sliding Gear (Large)	1
25	A-4513-A	Inner Cap	1
25A	A-4515-A	Universal Joint Husing Gasket	2
26	A-20905	Hex Head Bolt 3/8"-24 (x 1)	2
27	A-4520-C	Universal Joint Housing Cap	2
28	A-20953	Hex Head Bolt 3/8"-24 (x 1 7/32) with Cotter Hole	6
29	A-4516	Grease Seal (Cork or Felt)	1 set
30	A-4505-A	Torque Tube	1
31	A-7090	Universal Joint	1
32	A-20905	Hex Head Bolt 3/8"-24 (x 1)	1
33	A-22245	Lockwasher 3/8" (3/32 x 21/32)	1
34	A-7095	Front Knuckle Washer	1
35	A-21116	Hex Head Bolt 7/16"-20 (x 1) - Safety Wired	4

Note: * Early transmission cases (to January 1929) used one brass thrust washer at either end of the cluster gear.

**Model A Ford
TRANSMISSION
(continued)**

Index Number	Part Number	Nomenclature	Number Required
36	A-7085	Main Shaft Bearing Retainer	1
36A	A-7086	Bearing Retainer Gasket	1
37	A-21745	Castle Nut 3/8"-24 (13/32 x 9/16)	6
38	-	Cotter Pin (3/32 x 5/8)	6
39	A-24405	Grease Fitting	1
40	A-7065-BS	Main Shaft Bearing	1
41	A-7040	Main Drive Shaft Baffle	1
42	A-7063	Main Shaft Pilot Spacer	1
43	A-7060	Main Drive Gear Shaft	1
44	A-7045	Main Shaft Bearing Retainer Ring	1
45	A-7070	Bearing Retainer Snap Ring	1
46	A-7140	Reverse Idler Shaft	1
47	A-7111	Cluster Gear Shaft	1
48	-	Bolt	1
49	-	Lockwasher	1
50	A-7112	Countershaft & Reverse Idler Retainer	1